

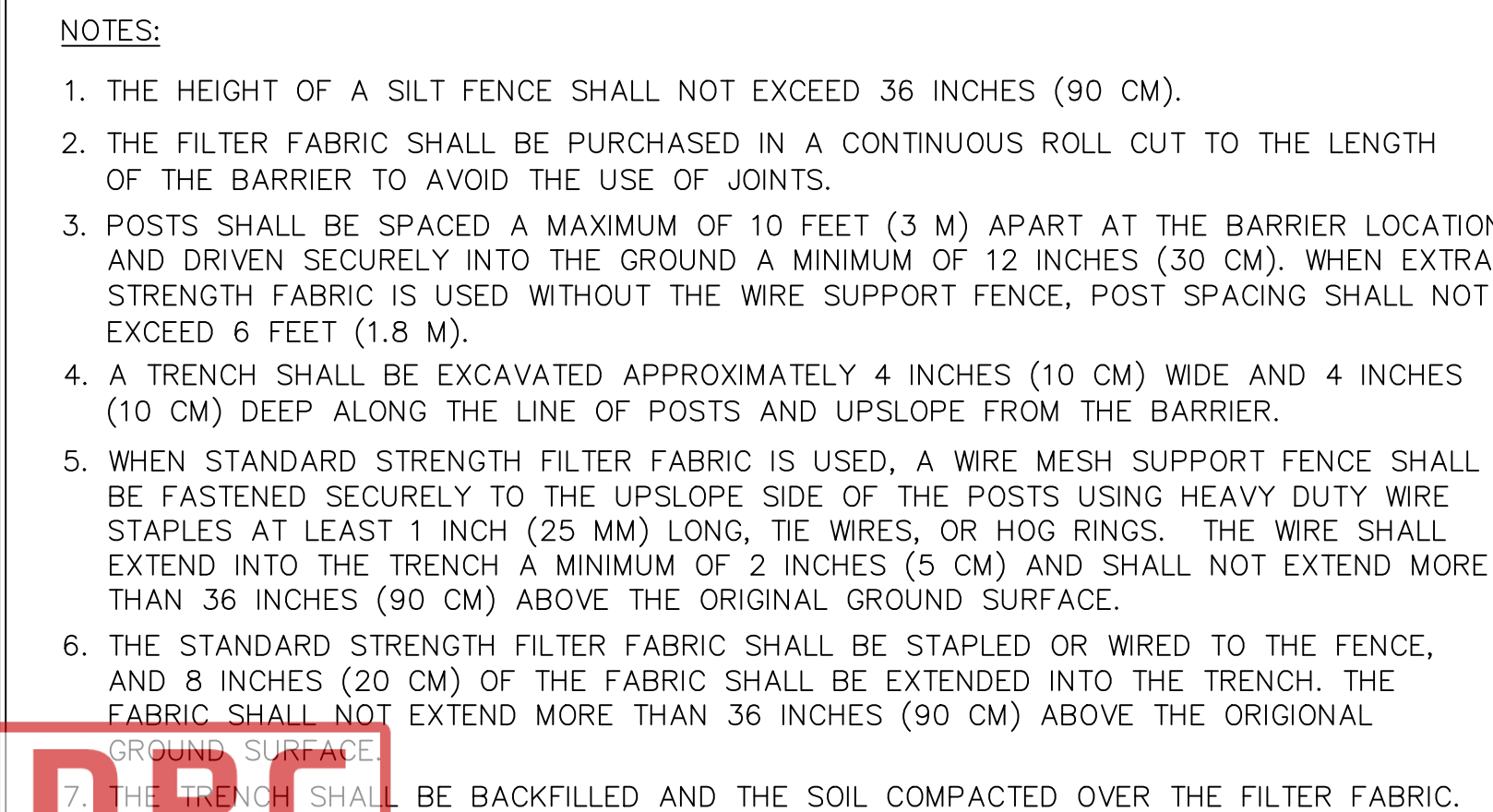

A SEDIMENT TRAP WILL BE EXCAVATED BEHIND THE CURB AT THE INLET. THE BASIN SHALL BE AT LEAST 12 TO 14 INCHES IN DEPTH, APPROXIMATELY 36 INCHES IN WIDTH AND APPROXIMATELY 7 TO 10 FEET IN LENGTH PARALLEL TO THE CURB.

STORM WATER WILL REACH THE SEDIMENT TRAP VIA CURB CUTS ADJACENT TO EACH SIDE OF THE INLET STRUCTURE. THESE OPENINGS SHALL BE AT LEAST 12 INCHES IN LENGTH. STORM WATER MAY ALSO REACH THE BASIN VIA OVERLAND FLOW LAND ARE, BEHIND THE CURB. THE CURB CUTS SHALL BE REPAIRED WHEN THE SEDIMENT TRAP IS REMOVED.

INLET FILTER DETAIL
N.T.S.



SILT FENCE INSTALLATION DETAIL D 9.1d
 000016 (Sheet 1 of 2) N.T.S.

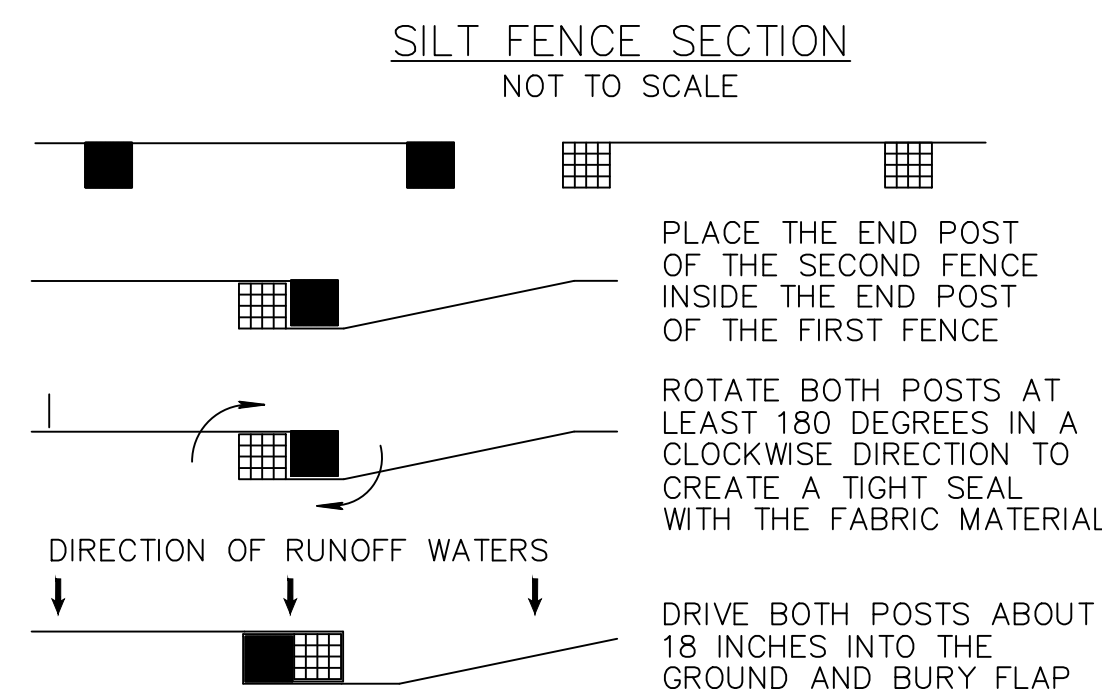

ATTACHING TWO SILT FENCES
NOT TO SCALE

SILT FENCE INSTALLATION DETAIL D 9.1b
(Sheet 2 of 2) N.T.S.

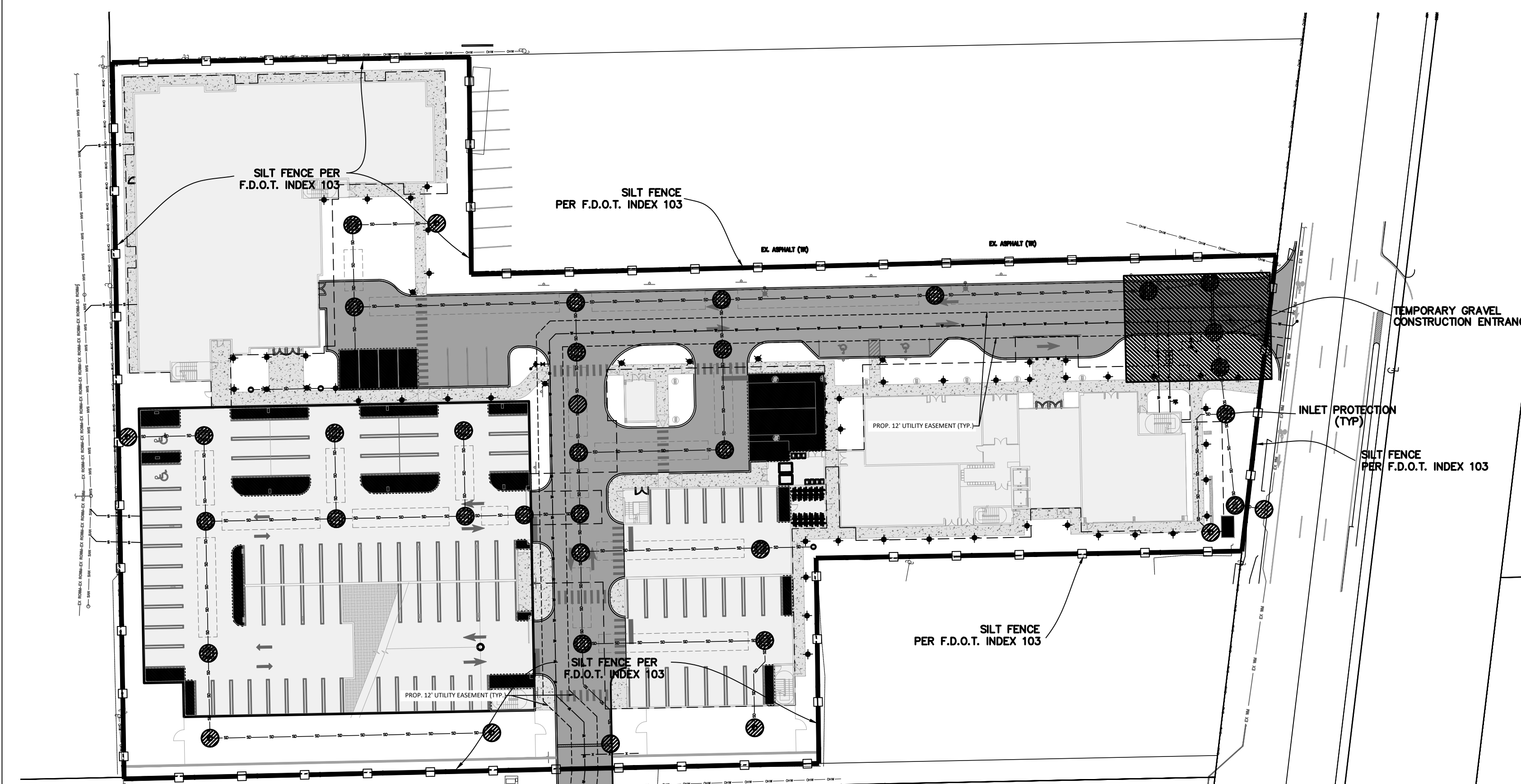
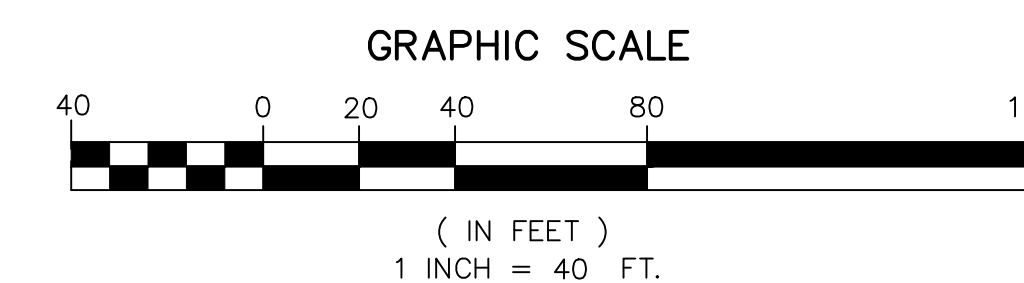
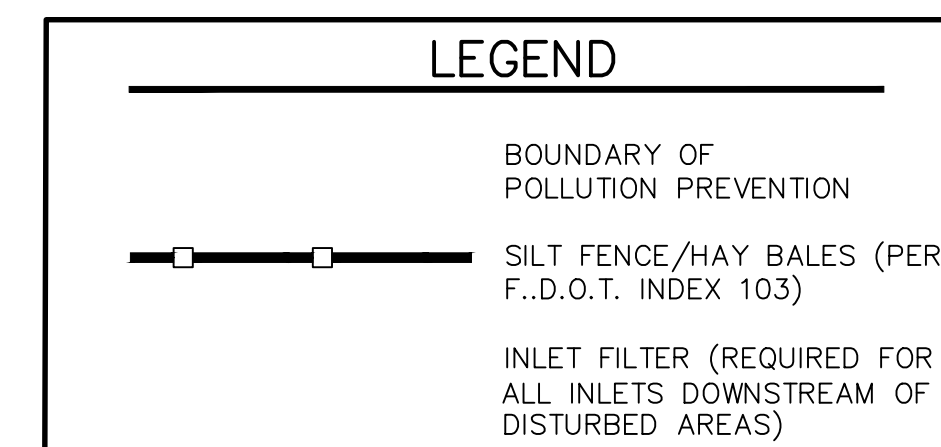
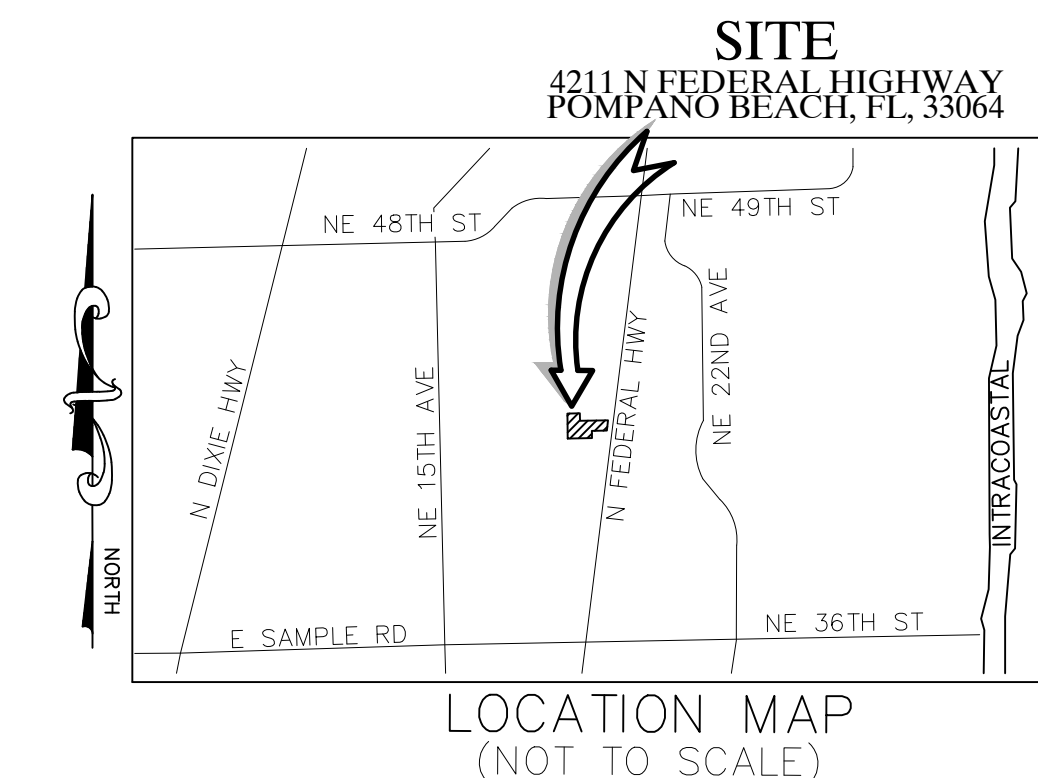
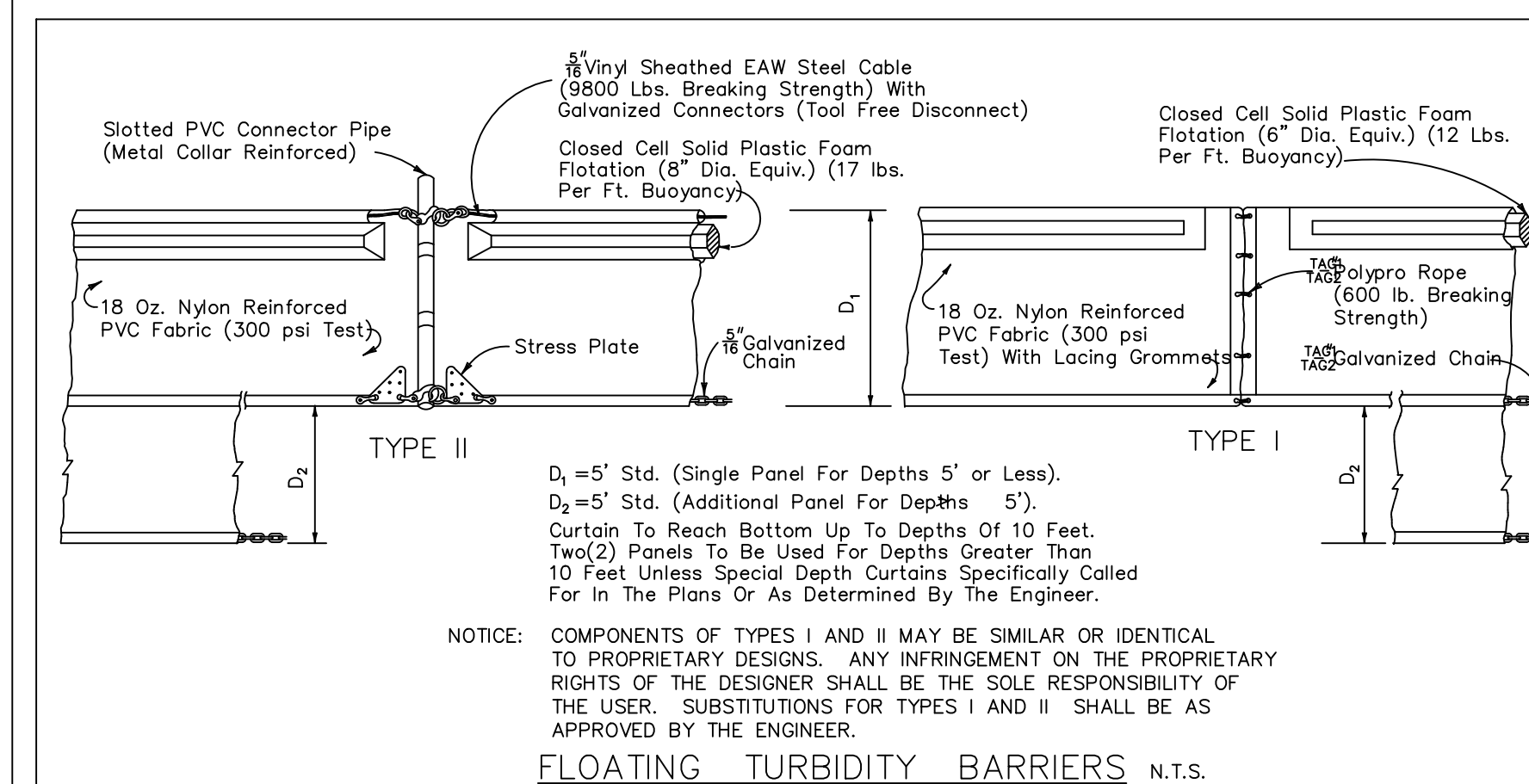

POLLUTION PREVENTION DETAIL

REV PER CITY COMMENTS		10/27/25	DJP
REV PER CITY COMMENTS		08/25/25	DJP
REVIEWS		DATE	BY
FILE NAME 1116GENC.docx			

CAULFIELD & WHEELER, INC.
CIVIL ENGINEERING
LANDSCAPE ARCHITECTURE - SURVEYING
7900 GLADES ROAD - SUITE 100
BOCA RATON, FLORIDA 33434
PHONE (561) 392-1991 / FAX (561) 750-1452

THE SATORI
4211 N FEDERAL HIGHWAY
PROPOSED POLLUTION PREVENTION
PLAN AND DETAILS
POMPANO BEACH, FL 33064

DATE	05/28/25
DRAWN BY	DJP
F.B./ PG.	----
SCALE	1" = 40'

MATTHEW V. KAHN
PROFESSIONAL ENGINEER
LICENSE NO. 82227
STATE OF FLORIDA
- FOR THE FIRM -
DATE

JOB # 11146
SHT.NO.
PP-1
OF 16 SHEETS